



Collegepond MS Webinar - INDIA University of Florida

Thursday, October 12, 2023
8:00 pm – 9:30 pm India Standard Time (10:30 am EST)



Presenters and Contacts



Toshi Nishida
Associate Dean for Academic Affairs
Professor of Electrical & Computer Engineering



Mike Nazareth
Director for Graduate Recruitment
mikenaz@eng.ufl.edu



Ashley Wilson
Coordinator for Graduate Recruitment
Ashley.Wilson@eng.ufl.edu

Current MS Student Panelists from India



Manan Rathod
Nirma University
Chemical Engineering
mananrathod@ufl.edu



Yash Bhalla
Anna University
Computer & Information Science & Engineering
yash.bhalla@ufl.edu

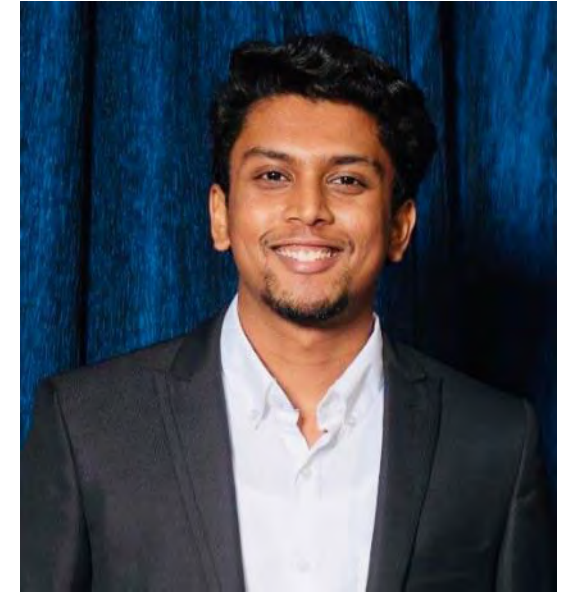

Manish Chowdary Ravipati
Visvesvaraya Technological University
Electrical & Computer Engineering
ravipatim@ufl.edu

Institutions in INDIA at University of Florida



Acharya Nagarjuna University	KLE Technological University
Ahmedabad University	Koneru Lakshmaiah Education Foundation
Aligarh Muslim University	Malaviya Natl Inst Tech Jaipur
Amity University	Manipal Academy of Higher Education
Amrita Vishwa Vidyapeetham	Manipal Institute of Technology
Andhra University	Manipal University
Anna University	Manipal University Jaipur
Banasthali University	Maulana Abul Kalam Aad University
Bennett University	Maulana Abul Kalam Azad University of Technology
Birla Institute of Technology and Science	Maulana Azad National Institute
Bml Munjal University	MIT-World Peace University
Charotar University of Science and Technology	Mody University of Science and Technology
Christ University	National Institute of Technology
Delhi Technological University	National Institute of Technology
Devi Ahilya Vishwavidyalaya	National Institute of Technology Calicut
Dharmasinh Desai University	National Institute of Technology Tiruchirappalli
Dr. A.P.J. Abdul Kalam Technic	Nirma University
Dr. Babasaheb Ambedkar Marathwada University	Nmims Deemed University
Gandhi Institute of Technology	Osmania University
Gitam University	PES University
GLA University	Punjab Technical University
Goa College of Engineering	Rajasthan Technical University
Gujarat Technological University	Rajiv Gandhi Proudhyogiki Vishw
Guru Gobind Singh Indraprastha	Rashtrasant Tukadoji Maharaj N
Hindustan Institute of Technology and Science	RIMT University
I K Gujral Punjab Technical University	Sandip Institute of Engineering & Manag
Indian Institute of Technology, Hyderabad	SASTRA Deemed University
Indian Institute of Technology, Bhilai	Sathyabama Institute of Science and Technology
Indian Institute of Technology, Bombay	Savitribai Phule Pune University
Indraprastha Institute of Info Tech	Shiv Nadar University
Jadavpur University	Solapur University
Jain University	SRM Institute of Science and Technology
Jawaharlal Nehru Technological	Symbiosis International School
Jaypee Institute of Information Technology	Thapar Institute of Engineering & Technology
JK Lakshmipat University	University of Kerala
JNTUH College of Engineering	University of Mumbai
Kakatiya University	Vellore Institute of Technology
Kalinga Institute of Technology	Visvesvaraya Natinal Institute of Technology
Karunya Institute of Technology	Visvesvaraya Technojical University

University of Florida

- Established 1853
- 2,000 Acres, 900 Buildings
- 60,795 Students; 19,743 Graduate Students
- 4,779 Ph.D.; 14,964 Masters/Professional
- 14 Colleges and Schools; 5,000+ Faculty
- \$1.25 Billion+ in Annual Research Expenditures
- UF Owned Lake Alice (on campus); Lake Wauburg (15 minute bus ride)

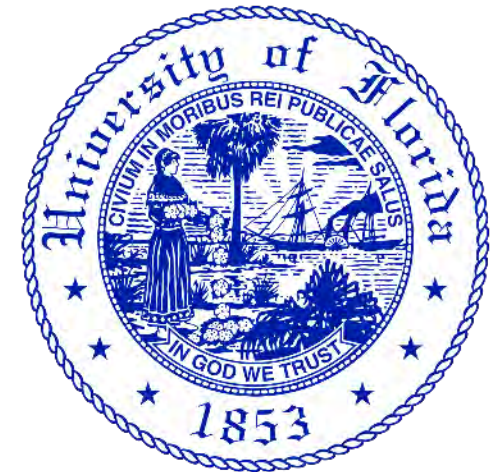

Herbert Wertheim College of Engineering

- Established 1910
- 11 Departments; 16 Degree Programs
- 300+ Faculty (tenure track)
- 10,686 Engineering Students
- 3,340 Graduate Engineering Students
 - Ph.D. = 1,109
 - Masters = 2,231



Rankings



#1 Public University per 2024 Wall Street Journal
<https://news.ufl.edu/2023/09/wsj-ranking/>



#6 Top Public University per 2024 U.S. News & World Report
<https://www.usnews.com/best-colleges/rankings/national-universities/top-public>

Departments and Degrees



- AEROSPACE ENGINEERING
- AGRICULTURAL & BIOLOGICAL ENGINEERING
- BIOMEDICAL ENGINEERING
- CHEMICAL ENGINEERING
- CIVIL ENGINEERING
- COASTAL & OCEANOGRAPHIC ENGINEERING
- COMPUTER ENGINEERING
- COMPUTER SCIENCE
- DIGITAL ARTS & SCIENCES
- ELECTRICAL ENGINEERING
- ENGINEERING EDUCATION
- ENVIRONMENTAL ENGINEERING SCIENCES
- INDUSTRIAL & SYSTEMS ENGINEERING
- MATERIALS SCIENCE & ENGINEERING
- MECHANICAL ENGINEERING
- NUCLEAR ENGINEERING SCIENCES

New Exciting MS Degrees

- MS of Applied Data Science
- MS of Artificial Intelligence Systems
- Engineering Education Department
- Faculty Lead: Professor Catia Silva
- <https://www.eng.ufl.edu/eed/programs/>
- MS Application Fee Waivers
- GRE Waived



Department Rankings

2023 U.S. News & World Report - Best Graduate Schools Rankings
<https://www.usnews.com/best-graduate-schools/top-engineering-schools>



Rankings Among Public Universities

- Agricultural and Biological Engineering – **No. 5**
- Materials Science and Engineering - **No. 8**
- Computer Science, Nuclear Engineering – **No. 12**
- Industrial and Systems Engineering - **No. 13**
- Electrical Engineering - **No. 14**
- Computer Engineering, Mechanical Engineering – **No. 15**
- Biomedical Engineering, Civil Engineering - **No. 17**
- Chemical Engineering - **No. 18**
- Aerospace Engineering, Environmental Engineering – **No. 19**

INDIA Students at UF Engineering/CS

Dept	Concentrations	MS	Ph.D.	Total
ABE	Agricultural, Biological	2	4	6
BME	Biomedical	13	1	14
CHE	Chemical	24	13	37
CISE	CE, CIS, CS, DS, MIS	729	14	743
ECE	Electrical, Computer	100	33	133
ESSIE	Civil, Coastal, Environmental	22	9	31
ISE	Industrial, Systems	19	1	20
MAE	Mechanical, Aerospace	47	8	55
MSE	Materials, Nuclear	13	5	18
	Total	969	88	1,057

Over 1,000,000 Gross Sq. Ft. of Engineering Facilities

NAME	SQ. FT.
JOSEPH WEIL HALL	87,282
ENGINEERING	77,728
FREDERICK N RHINES HALL	47,220
COMPUTER SCIENCES/ENGINEERING	44,345
COASTAL ENGINEERING WAVE TANK	39,917
NUCLEAR SCIENCES	37,126
RESEARCH ENGINEERING EDUCATION FACILITY (REEF)	31,052
CHEMICAL ENGINEERING	30,845
NANOSCALE RESEARCH FACILITY	25,775
BIOMEDICAL SCIENCES BUILDING	25,519
MATERIALS ENGINEERING	22,971
MECHANICAL & AEROSPACE ENG A	22,492
MECHANICAL & AEROSPACE ENG B	20,480
MECHANICAL & AEROSPACE ENG C	19,729
MERWIN J. LARSEN HALL	19,162
PARTICLE SCIENCE & TECHNOLOGY	18,424
ALVIN P. BLACK HALL	17,608
THE POWELL FAMILY STRUCTURES AND MATERIALS LABORATORY	17,450
JOHN R. BENTON HALL	14,995
CCE FACULTY / STAFF	9,426
NUCLEAR REACTOR	9,393
QUALIFICATION LAB, CTT	6,204
PERCY L. REED LABORATORY	5,511
EARLE B. PHILIPS LAB	5,416
CHEMICAL ENGINEERING STUDENT CENTER	5,341
NUCLEAR FIELD BUILDING	5,217
POLYMER RECYCLING BUILDING	4,631
COASTAL ENGINEERING SHOPS	4,197
32 REMAINING BUILDINGS	35,215
TOTAL	710,652

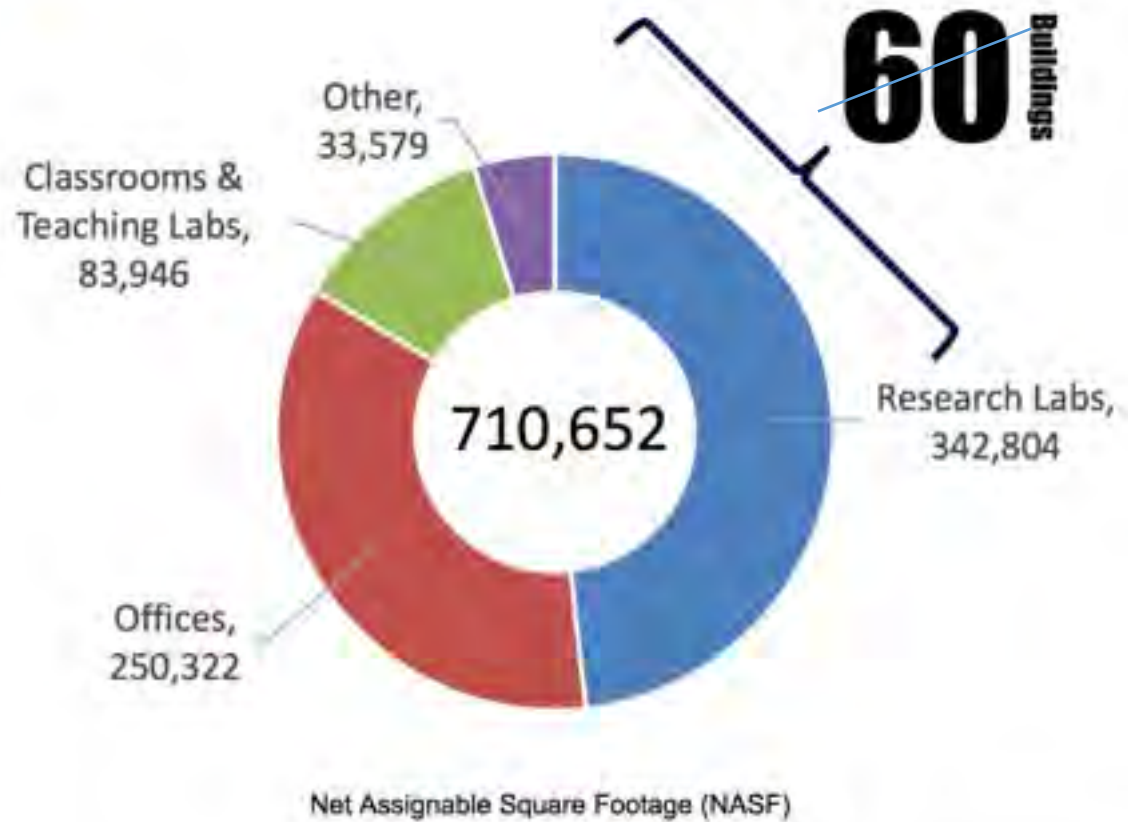

Source: UF Space Tracking & Reporting System (STARS)

Opened Fall 2020

State-of-the art biotech lab
Prototyping labs
Global teleconferencing lab
Collaboration spaces
Classrooms

**HERBERT WERTHEIM LABORATORY
FOR ENGINEERING EXCELLENCE**

AI Partnership with NVIDIA

- **UF houses the fastest AI supercomputer in higher education**
- The third-generation HiPerGator with NVIDIA's most advanced AI software integrating 140 NVIDIA DGX™ A100 systems with 1,120 NVIDIA A100 Tensor Core GPUs and high-performance NVIDIA Mellanox HDR 200Gb/s InfiniBand networking to deliver 700 petaflops of AI performance.

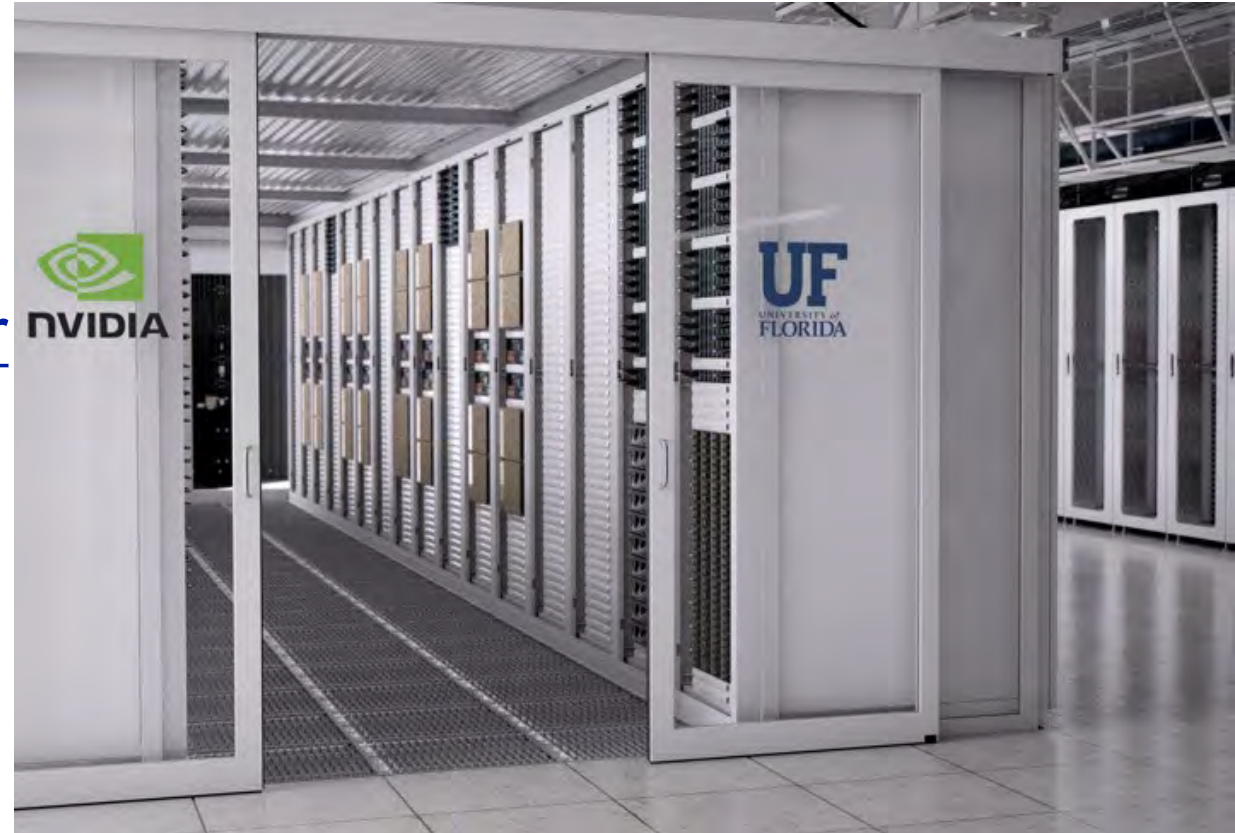

Malachowsky Hall for Data Science & Information Technology

- **\$150M Investment**
- **Home of the AI University**
 - Headquarters for CISE and ECE
 - ICLASSROOM 2.0
 - Highly experiential – Hands on labs for VR, AI, Cybersecurity, IOT, GPU
- **Opening November 2023**

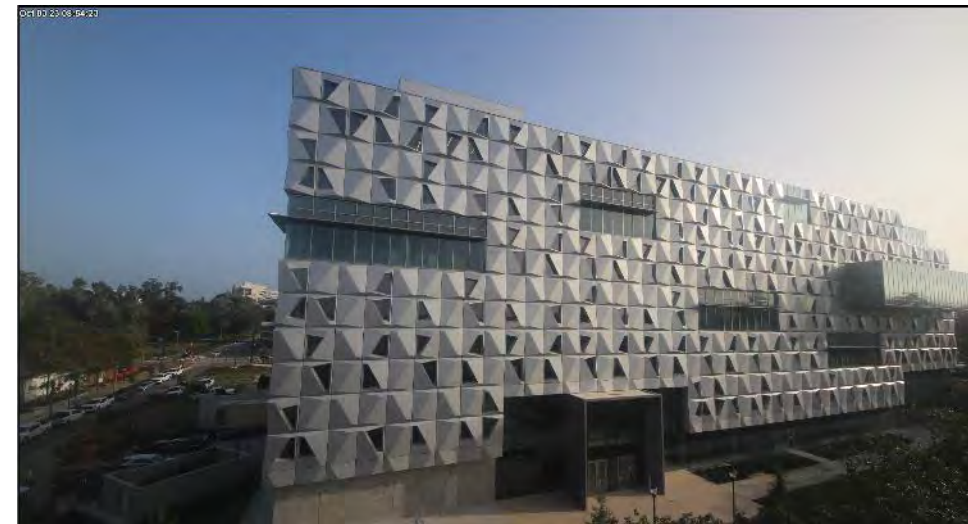

The logo consists of the letters 'UF' in a white, bold, sans-serif font, centered within a solid orange square. The background of the entire slide is a photograph of a brick building with a large alligator sculpture on a globe in the foreground, overlaid with a blue geometric pattern.

UF

F-1 International Student Compliance Services

UF International Center

Incoming F-1 Students <https://internationalcenter.ufl.edu/>

- Estimated Start-Up Costs
- I-20 Process for F-1 Degree Students
- F-1 Visa: U.S. Embassies and Consulate Offices
- UF Critical Dates & Deadlines
- Arriving In Gainesville
- Mandatory Online Check-In Process
- F-1 Student Status Requirements
 - Maintaining F-1 Visa Status
 - Registration Requirements
 - Employment/Training Restrictions

(Detailed information provided at each link!)

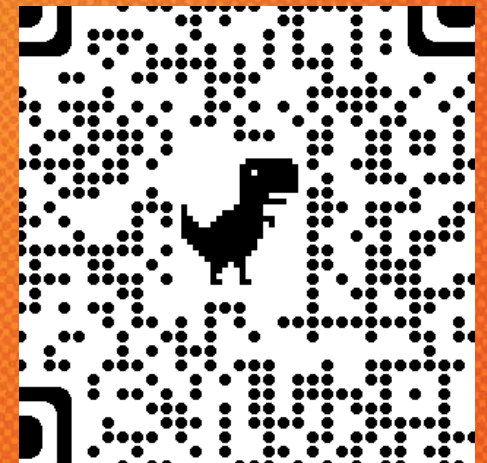

Estimated Start-Up Costs: 2024

- Grad Students: \$57,323* per year
 - If you have the \$4,500 Achievement Award: \$52,823* per year

**Numbers subject to change.*

I-20 Process

- 1) I-20 request submitted in the ISSS Portal by Academic Department
- 2) ISS reviews request, sends email with instructions to student
 - Sent to same email address student used to apply to UF
- 3) Student receives email with instructions to log into the ISSS portal
 - Remember to click ***SUBMIT APPLICATION***
- 4) Student's F1 Advisor reviews I-20 application & documents, follows up as needed, issues I-20
- 5) Email sent to student with instructions to download & print the I-20 through ISSS portal

Department of Homeland Security
U.S. Immigration and Customs Enforcement

I-20, Certificate of Eligibility for Nonimmigrant Student Status
OMB NO. 1653-0038

SEVIS ID: NO0 [REDACTED]

SUBSAMI PRIMARY NAME [REDACTED]	GIVEN NAME [REDACTED]	Class of Admission F-1 ACADEMIC AND LANGUAGE
PREFERRED NAME [REDACTED]	PASSPORT NAME [REDACTED]	
COUNTRY OF BIRTH INDIA	COUNTRY OF CITIZENSHIP INDIA	
CITY OF BIRTH [REDACTED]	DATE OF BIRTH [REDACTED]	
FORM ISSUE REASON INITIAL ATTENDANCE	ADMISSION NUMBER [REDACTED]	

SCHOOL INFORMATION

SCHOOL NAME University of Florida	SCHOOL ADDRESS 300 SW 13TH ST, PO Box 113150, GAINESVILLE, FL 32601
SCHOOL OFFICIAL TO CONTACT UPON ARRIVAL Ethel Porras International Student Adviser	SCHOOL CODE AND APPROVAL DATE M2324F0013500 25 JANUARY 2023

PROGRAM OF STUDY

EDUCATION LEVEL MAJORS Required	MAJOR 1 Systems Engineering 14.2701	MAJOR 2 None 00.0000
PROGRAM ENGLISH PROFICIENCY Required	ENGLISH PROFICIENCY NOTES Student is proficient	EARLIEST ADMISSION DATE 24 JULY 2021
START OF CLASSES 23 AUGUST 2021	PROGRAM START/END DATE 23 AUGUST 2021 - 23 AUGUST 2023	

FINANCIALS

ESTIMATED AVERAGE COSTS FOR: 12 MONTHS		STUDENT'S FUNDING FOR: 12 MONTHS	
Tuition and Fees	\$ 30,130	Personal Funds	\$ 0
Living Expenses	\$ 20,140	Achievement Award	\$ 4,500
Expenses of Dependents (0)	\$ 0	Family Funds	\$ 45,770
Other	\$ 0	On-Campus Employment	\$ 0
TOTAL	\$ 50,270	TOTAL	\$ 50,270

REMARKS

I-20 update due to admission deferral.

SCHOOL ATTESTATION

I certify under penalty of perjury that all information provided above was entered before I signed this form and is true and correct. I executed this form in the United States after review and evaluation in the United States by me or other officials of the school of the student's application, transcripts, or other records of courses taken and proof of financial responsibility, which were received at the school prior to the execution of this form. The school has determined that the above named student's qualifications meet all standards for admission to the school and the student will be required to pursue a full program of study as defined by 8 CFR 214.2(f)(6). I am a designated school official of the above named school and am authorized to issue this form.

SIGNATURE OF: Ethel Porras, International Student Adviser

DATE ISSUED: 29 August 2020

PLACE ISSUED: GAINESVILLE, FL

STUDENT ATTESTATION

I have read and agreed to comply with the terms and conditions of my admission and those of any extension of stay. I certify that all information provided on this form refers specifically to me and is true and correct to the best of my knowledge. I certify that I seek to enter or remain in the United States temporarily, and solely for the purpose of pursuing a full program of study at the school named above. I also authorize the named school to release any information from my records needed by DHS pursuant to 8 CFR 214.5(g) to determine my nonimmigrant status. Parent or guardian, and student, must sign if student is under 18.

SIGNATURE OF: [REDACTED]

DATE: [REDACTED]

NAME OF PARENT OR GUARDIAN: [REDACTED]

SIGNATURE: [REDACTED]

ADDRESS (city/state or province/country): [REDACTED]

DATE: [REDACTED]

ICE Form I-20 (04/30/2021) Page 1 of 3

U.S. Embassy and Consulates

- Receive I-20 → Pay SEVIS fee → *Complete and Save Form DS-160 Visa Application Form* → Schedule F-1 visa appointment at U.S. Embassy or Consular office
 - Among any other documents required for the visa appointment, make sure to have your **PRINTED** documents with you: I-20, admission letter, proof of funds, and passport
- Obtain F1 visa → Schedule flight → Enter the U.S. → Complete the UFIC Online Check-In → Register for Classes



Arriving In Gainesville, FL

- Travel with your I-20, admission letter, F1 visa, passport on your person; **DO NOT PACK DOCUMENTS IN CHECKED LUGGAGE, DO NOT LOSE!** Scan a copy of all documents to keep digitally just in case.
- Can enter U.S. no more than 30 days before program start date stated on your I-20
- Keep in mind, many affordable off-campus apartments are leased through July 31, need turn-over/cleaning time, and may not be available for move-in until ~ August 8-14

Mandatory Check-In Process

- Must complete the F-1 online check-in process in the ISSS Portal
<https://internationalcenter.ufl.edu/f-1-student/new-f-1-students/check-process>
- Must be completed before the start of classes or by the drop/add deadline
- If the mandatory check-in is not completed within deadline, your F1 status is terminated

UF Critical Dates & Deadlines: 2023

- Advance/Regular registration deadline (no late fee):
March 27 – August 21
- First day of classes: **August 23**
- Drop/Add registration deadline (late fee applied if not previously registered): **August 23-29**
- Fee payment deadline (course dropped if fee not paid; this is an F1 status issue): **September 1**



Maintaining F1 Student Status

Full Time Registration:

- Fall and Spring Semesters
 - **Graduate** students: **9** credits each semester
 - This includes 3 credits online maximum per semester
- Summer Semester (If admitted to a summer semester)
 - **Graduate** students: **6** credits
 - This includes 3 credits online maximum per semester



Employment/Training as an F1 Student

- Limited to 20 hours per week and on the UF campus
- Cannot work off campus at all in first academic year; authorization always required for off campus work/training
- Must apply for and receive CPT authorization on I-20 to work/train off campus prior to graduation
- Must apply for and receive OPT authorization card to work/train after graduation

F-1 Advisors

Questions? Contact [your specific F1 international student advisor](#) according to the first letter of your **Surname/Family Name**
(Scan QR Code for contact information)

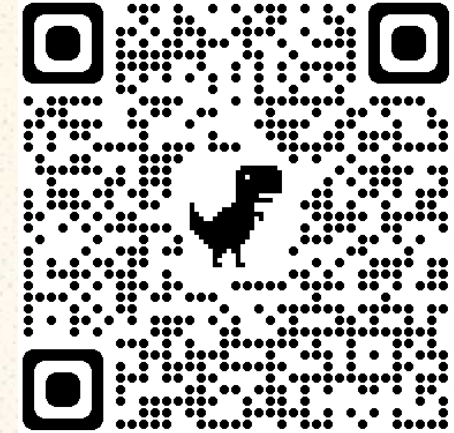

More Information

- Click "[I-20 Process](#)" for general yet informative information.
- All I-20 instructions (including Proof of Funds information) is in the email you'll receive from the ISSS Portal if you're admitted and we receive an I-20 request for you
- Please read and follow the instructions carefully to then submit your I-20 application.
 - *If you do not click SUBMIT APPLICATION at the top of the application window once complete, we will not receive your I-20 application.*

Master's Degrees

- Masters with on-campus studies
 - average of 1.5 to 2 years (3 to 4 semesters)
 - course based, more technical expertise
 - thesis/research based
- Masters with EDGE online distance studies
 - average of 1.5 to 2 years (3 to 4 semesters)
 - reside at Home, do not move to Gainesville
 - up to 50% reduced tuition discounts
- Pathway to Ph.D.
 - many HWCOE MS students continue to the Ph.D. at UF
 - distinct advantage for MS students performing well vs. new Ph.D. applicants



Master's Admissions

- Fall 2023 Master's Enrollment
- 4,431 Applications
- 2,047 Admitted (46%)
- 690 Enrolling (34%)
- Averages Cumulative GPA = 3.56
- GRE, Verbal = 151, Quantitative = 164
Waived for All Depts (except CISE) for Fall 2023/2024
- TOEFL = 80+; IELTS = 6+, GRE Verbal = 140+



Master's Admissions from INDIA

- Fall 2023 Master's Enrollment
- 2,234 out of 4,431 Applications (50%)
- 774 out of 2,047 Admitted (38%)
- 335 out of 690 Enrolling (49%)
- GRE, Verbal = 151, Quantitative = 164
Waived for all Depts (except CISE) for Fall 2023/2024
- TOEFL Average Scores = 103
- Listening (27), Reading (26), Writing (25), Speaking (25)



GRE Test Required



Department	GRE Required for MS
Agricultural and Biological Engineering	No
Biomedical Engineering	No
Chemical Engineering	No
Civil, Coastal, Environmental Engineering	No
<i>Computer and Information Sciences and Engineering</i>	<i>Yes</i>
Electrical and Computer Engineering	No
Engineering Education	No
Industrial and Systems Engineering	No
Materials Science and Engineering; Nuclear Engineering	No
Mechanical and Aerospace Engineering	No

Dept Areas for MS Admissions

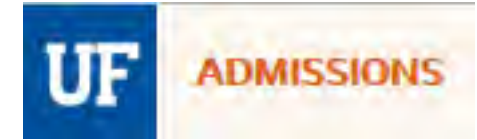

Dept	Areas	GPA	Application Deadline
ABE	agricultural, biological	3.0+ (6 to 6.5 for India)	12/5
BME	biomedical, mollecular, neural	3.0+ (6 to 6.5 for India)	1/31
CHE	chemical, energy, nano, petroleum	3.0+ (7.0+ for India)	1/15
CISE	CS, computer, data science, software	3.3+ (6 to 6.5 for India)	2/1 international; 5/1 domestic
ECE	electrical, computer, hardware, cybersecurity, machine learning	3.0+ (6 to 6.5 for India)	1/31 international; 4/1 domestic
EED	engineering education, applied data science, artificial intelligence	3.0+ (6 to 6.5 for India)	1/31 international; 4/1 domestic
ESSIE	civil, coastal, environmental	3.0+ (6 to 6.5 for India)	3/1 international; 6/1 domestic
ISE	industrial, systems, human-computer	3.3+ (6 to 6.5 for India)	12/31
MAE	mechanical, robotics, aerospace	3.0+, 3.3+ (7+, 7.5+ for India)	3/1 international; 6/1 domestic
MSE	materials, metallurgy, nano, nuclear	3.0+ (6 to 6.5 for India)	12/5 priority; 60 days prior

All UF Engineering and Computer Science MS & PhD. Areas of Specialization

<https://www.eng.ufl.edu/graduate/prospects/areas-of-specialization/>

MS Application Fee Waiver Consideration

Deadline of Friday, December 22, 2023

Dept	International Students	U.S. Citizen or Permanent Resident	Contact for U.S. Citizens or Perm.
ABE	Yes	None Available	
BME	Yes	None Available	
CHE	Yes	Yes	grad@che.ufl.edu
CISE	None Available	None Available	
ECE	Yes	None Available	
EED	Yes	None Available	
ESSIE	Yes	Yes	gradinfo@essie.ufl.edu
ISE	Yes	None Available	
MAE	Yes	Yes	gradadmissions@mae.ufl
MSE	Yes	None Available	

Waiver Details: <https://www.eng.ufl.edu/graduate/prospects/masters-admission/>

Waiver Request: <https://www.eng.ufl.edu/graduate/mswaiver/>

\$30 U.S. for UF MS Admissions Application Fee; one of most economical in U.S.



Statement of Purpose

- Goal of enrolling Master's
- Why do you want to attend that institution?
- Faculty, programs, areas of specialization, facilities, research interests
- Highlight your research, job, computing experience
- Highlight some notable resumes qualifications such as internships, leadership positions, volunteering, community service, mentoring, etc.
- Maximum 1-2 page, less is better, be specific



Letters of Recommendation

- Typically 3 required letters, check institution requirements
- Minimum 2 academic (undergraduate research mentor, faculty who know you well, lab team project mentor, etc.); No family, friends, GSI/TA
- Contact faculty early, schedule an appointment to discuss, provide bullet points, resume, unofficial transcript, state of purpose draft, addressed envelopes, online submissions/formats, deadlines, offer draft, etc.
- Request Strong Letter!
- Send faculty reminders throughout the semester



Cost of Attendance



~\$30,000 Annual Tuition

<https://www.sfa.ufl.edu/cost/graduate-costs/>

Institution	Rank	Tuition	City
University of Florida	1	\$30,138	Gainesville, FL
Georgia Institute of Technology	2	\$32,876	Atlanta, GA
University of North Carolina	3	\$39,338	Chapel Hill, NC
University of Texas at Austin	4	\$41,070	Austin, TX
University of California Davis	5	\$46,043	Davis, CA
University of California Irvine	6	\$47,759	Irvine, CA
University of California Los Angeles	7	\$46,326	Los Angeles, CA
University of California Berkeley	8	\$48,465	Berkeley, CA
University of California San Diego	9	\$48,630	San Diego, CA
University of Michigan	10	\$57,273	Ann Arbor, MI
University of Virginia	11	\$58,950	Charlottesville, VA

Out of State Tuition

<https://www.usnews.com/best-colleges/rankings/national-universities/top-public>

Institution	Rank	City	Cost of Living
University of Florida	1	Gainesville, FL	90
National Average Cost of Living Index for U.S. A. Cities = 100			
University of Virginia	2	Charlottesville, VA	107
Georgia Institute of Technology		Atlanta, GA	109
University of Michigan	3	Ann Arbor, MI	111
University of North Carolina	4	Chapel Hill, NC	116
University of Texas	5	Austin, TX	129
University of California Davis	6	Davis, CA	154
University of California San Diego	7	San Diego, CA	160
University of California Los Angeles	8	Los Angeles, CA	176
University of California Irvine	9	Irvine, CA	181
University of California Berkeley	11	Berkeley, CA	238

National Average Cost of Living = 100

<https://www.bestplaces.net/cost-of-living/>

Masters Funding Options

- Academic Achievement Award
 - no limit on quantity of awardees
 - guaranteed \$4,500 for non-Florida Residents
 - \$1,500 for 3 semesters
- EDGE Online Distance Learning
 - no limit on enrollment
 - significant discounted tuition
 - cannot be combined with Academic Achievement Award



Industry Connections

- UF Career Connection Center
 - UF Career Showcase Twice Annually
 - Individual Company Visits - Weekly Year Round
 - Largest in Southeast U.S.A. with 600+ Companies
 - Some Companies Recruiting India Students with VISA options
 - Intel, Citrix, Paypal, Oak Ridge National Labs, InfoTech, Fanatics, etc.
 - Engineering Departments with Separate Career Fairs
 - BME Industry & Alumni Connect
 - CISE Career Development Workshop
 - ESSIE Evening with Industry
- ISE Career Fair
 - MAE Internship Course
 - MAE Webinar Industry Insights



BME Industry & Alumni Connect

- Networking directly with industry reps for employment/internships
- Career advice and “insider” knowledge from BME alumni
 - Various career paths: industry, academia, government, start-up, etc.



UF BME INDUSTRY CONNECT CAREER FAIR & MORE!
MARCH 30 & 31, 2022

Wednesday, March 30, 9AM-12PM

8:45AM Student Check-in BMS Atrium

9:00AM - 12:00PM Talking Session BMS Atrium

9:00AM - 12:00PM Open Discussion Session w/ Breakout Activities BMS J632

Thursday, March 31, 9AM-12PM

9:00AM Special Presentation from Arthro, Inc. Connections Room, Career Center, Reitz Union (In-person) breakfast provided!

11:15AM-12:15PM Virtual Info Session with ZimVie (formerly Zimmer Biomet Dental)

Arthro | ZimVie

Accelus | akogen | Biosense Webster | BOSTON ENGINEERING | CALYX | Exactech | GE Healthcare | KLS martin GROUP | Lacerta | RESILIENCE | TERUMO Aortic | ThermoFisher

9:00AM - 9:20AM RESILIENCE | 10:30AM - 10:50AM Biosense Webster | 9:30AM - 9:50 AM KLS martin GROUP | 11:00AM - 11:20AM Accelus | 10:00AM - 10:20AM GE Healthcare | 11:30AM - 11:50AM CALYX



2021 BME ALUMNI CONNECT

NOVEMBER 1-5
12-1 PM EACH DAY

Zoom Link:
946 5251 1509
584547

Join us for an exciting week of speakers from a variety of professional sectors including medicine, industry, academia, and more!

UF UNIVERSITY OF FLORIDA
College of Engineering
ENGINEERS for LIFE.

PANELISTS

TUESDAY
Only 7:00 a.m. - 9:00 a.m.

WEDNESDAY
9:00 a.m. - 12:00 p.m.

THURSDAY
12:00 p.m. - 1:00 p.m.

CISE Career Showcase (100+ Companies)



ESSIE Evening with Industry



ISE Career Fair



Indian Graduate Student Assoc.



- Cater to the Needs and Concerns of Indian Graduate Students
- Provide Accessible Platform to Present Indian Identity within the International Community at University of Florida
- Provide Smooth Assimilation and Orientation for Indian Graduate Students into the UF Environment and Gainesville Community





Sajeed Mohhamad
President, IGSA

I n d i a n
G r a d u a t e
S t u d e n t
A s s o c i a t i o n
(I G S A)



OUR TEAM

Indian Graduate Student Association IGSA

- The Indian Graduate Student Association is a non-profit (student) organization committed to cater to the needs and concerns of Indian graduate students and provide an accessible platform to present their identity within the international community at the University of Florida (UF).
- IGSA promotes the smooth assimilation of Indian graduate students, primarily of international student status into the UF environment and local Gainesville community.
- IGSA provides student pickups (spring/fall), conducts webinars for incoming students, maintains dedicated WhatsApp group for every intake to answer and guide incoming students, conducts various fun and academic events, guides as a medium between student and UF and much more.

Spring 2023 Group:

<https://chat.whatsapp.com/BYZYalp5j9s4ogab2I3F9N>

Fall 2023 IGSA

- WhatsApp/Call: Sajeed @ +1-352-284-8306
- WhatsApp groups and more information

Website: <https://igsauf.weebly.com/>

Email: igsa.uf@gmail.com

Facebook: <https://www.facebook.com/IGSAUFL>

Instagram: [@igsa.uf](https://www.instagram.com/igsa.uf)

Twitter: [@igsa_uf](https://twitter.com/igsa_uf)

Housing

On Campus



- The Continuum for Graduate Students or UF Working Professionals
- On-Campus Housing (graduate and family): Corry Village (1-3 bedroom options), Diamond Village(1-2 bedroom options), Tanglewood Village(1-2 bedroom options)
- Applying for Graduate and Family Housing: <https://housing.ufl.edu/apply/graduate-and-family-housing-application/>

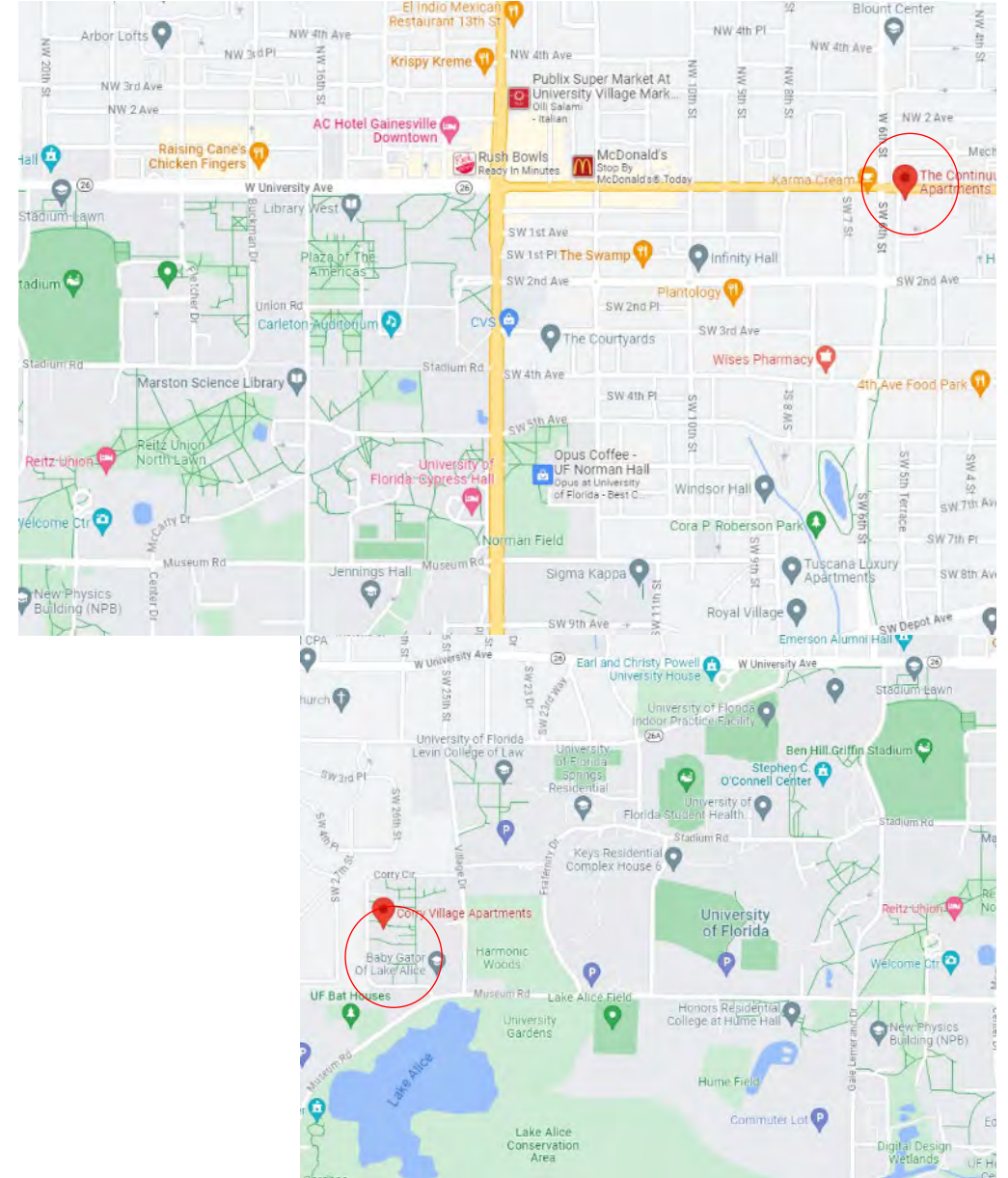

Housing

Off Campus

- Off-Campus Housing:

- <https://www.swamprentals.com/>
- <https://www.apartments.com/gainesville-fl/>

- Housing Options:

- The Pavilion
- The Ridge at Gainesville
- Cabana Beach Apartments
- Housing Locator: <https://housing.offcampus.ufl.edu/>

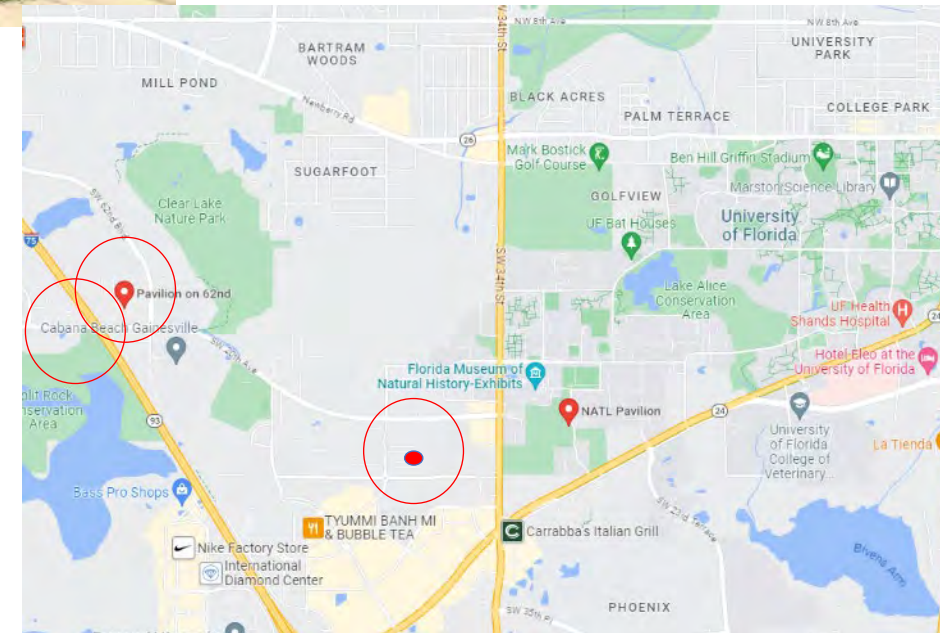

Gators



- 42 NCAA National Championships
- Top 10 for 32 Straights Years for NCAA Div. 1 National All-Sports Standings
- Ben Hill Griffin Football Stadium seats 88,548
- Exactech Arena seats 12,633
- **Southeastern Conference (SEC)**
Florida, Georgia, South Carolina, Missouri, Kentucky, Vanderbilt, Tennessee, Alabama, Texas A&M, LSU, Mississippi St., Auburn, Mississippi, Arkansas



G a i n e s v i l l e , F L

- Settled 1854
- Population of 141,341
- Average Annual Temperature of 81 degrees
- 80 minutes to Atlantic Ocean; 60 minutes to Gulf of Mexico
- 2 hours to Tampa or Orlando & 90 minutes to Jacksonville
- Gainesville ranks no. 13 on Money Inc's 20 Best Places to Live in Florida, December, 2022
- Gainesville ranks no. 11 on BestCollegeReviews.org's 50 Best College Towns in America, October 2022



Things to do in and near Gainesville



MS Interest & Application Fee Waiver Request

<https://www.eng.ufl.edu/graduate/mswaiver/>

MS Prospects

<https://www.eng.ufl.edu/graduate/prospects/masters-prospects/>

MS Admissions

<https://www.eng.ufl.edu/graduate/prospects/masters-admission/>

India Prospects

<https://www.eng.ufl.edu/graduate/prospects/india/>

MS Webinar Slides & Recordings

All Presentation Slides & Recordings Posted Here After Webinar
<https://www.eng.ufl.edu/graduate/prospects/virtual-events-webinars/>

UF Herbert Wertheim College of Engineering
Zoom Webinar for Admitted Master's Students from India (4-6-23)

Presenters

Sandeep Jalui
Rajiv Gandhi Institute of Technology
Electrical & Computer Engineering
sjalui@ufl.edu

Chaitya Lodaya
Vivekanand Education Society's Institute of Technology, VESIT
Electrical & Computer Engineering
chaitya.lodaya@ufl.edu

Kartikey Reddy
Dayananda Sagar College of Engineering
Electrical & Computer Engineering
k.reddy@ufl.edu

Sajeed Mohammad
VNR Vignana Jyothi Institute of Engineering and Technology, Hyderabad
Electrical & Computer Engineering
Indian Graduate Student Association (IGSA)
mnu@ufl.edu

Watch on YouTube

Contacts

Mike Nazareth

Director of Graduate Recruiting
mikenaz@eng.ufl.edu

Ashley Wilson
Coordinator of Graduate Recruiting
ashley.wilson@eng.ufl.edu



Manan Rathod
MS Student CHE Department
mananrathod@ufl.edu

Yash Bhalla
MS Student CISE Department
yash.bhalla@ufl.edu

Manish Chowdary Ravipati
MS Student ECE Department
ravipatim@ufl.edu

HWCOE Graduate Staff Contacts

Staff	HWCOE	Mike	Nazareth	mikenaz@eng.ufl.edu
Staff	HWCOE	Ashley	Wilson	ashley.wilson@eng.ufl.edu
Staff	ABE	Daphne	Flournoy	dflournoy@ufl.edu
Staff	BME	Krista	Smith	grad@bme.ufl.edu
Faculty	CHE	Sumant	Patankar	spatankar@che.ufl.edu
Staff	CISE	Kristina	Sapp	klsapp@ufl.edu
Staff	ECE	Julissa	Nunez	office@ece.ufl.edu
Staff	EED	Pam	Simon	phs@ufl.edu
Staff	ESSIE	Paula	Johns	gradinfo@essie.ufl.edu
Staff	ISE	Jordan	Sharpshair	isegradapps@ise.ufl.edu
Staff	MAE	Megan	McMahon	gradadmissions@mae.ufl.edu
Staff	MSE	Tahara	Franklin	advising@mse.ufl.edu

HWCOE Current MS Student Assistance

UF Dept	First Name	Last Name	Email	Undergraduate Institution	Country
BME	Naphtali	Mensah	Mensahnaphtali18@gmail.com	University of Education, Winneba	Ghana
BME	Madhushree Sunil	Sultane	msultane@ufl.edu	MIT ADT University	India
BME	Thanusha	Yaddala	yaddala.thanusha@ufl.edu	Saveetha University	India
BME	Qiang	Yang	yang.qiang@ufl.edu	Nanjing University of Aeronautics and Astronautics	China
CHE	Hai	Doan	haidoan@ufl.edu	Pennsylvania State University	Vietnam
CHE	Ria	Patkeshwar	rpatkeshwar@ufl.edu	Institute of Chemical Technology	India
CHE	Manan	Rathod	mananrathod@ufl.edu	Nirma University	India
CHE	Harshal	Sarode	harshal.sarode@ufl.edu	Rashtrasant Tukadoji Maharaj Nagpur University	India
CISE	Prateek	Abbi	prateekabbi@ufl.edu	Amity University	India
CISE	Syed Faizan	Ali	Syed.ali1@ufl.edu	Amity University	India
CISE	Aseem	Baranwal	a.baranwal@ufl.edu	Madan Mohan Malaviya University of Technology	India
CISE	Yash	Bhalla	yash.bhalla@ufl.edu	Visvesvaraya Technological University	India
CISE	Yash	Bhalla	yash.bhalla@ufl.edu	Visvesvaraya Technological University	India
CISE	Mohit Parmanand	Budhwani	mbudhwani@ufl.edu	University of Mumbai	India
CISE	Mathew	George	mathewg0408@gmail.com	National Institute of Technology, Calicut	India
CISE	Suneet	Jain	suneetjain@ufl.edu	Bennett University	India
CISE	Utkarsh	Jogani	utkarshjogani@ufl.edu	Visvesvaraya Technological University	India
CISE	Sayali	Kedar	sayaliskedar@gmail.com	Bharati Vidyapeeth College of Engineering for Women	India
CISE	Venkata Harsha Sarat Chandra	Konda	vkonda1@ufl.edu	National Institute of Technology Calicut	India
CISE	Sushanth Reddy	Kotha	su.kotha@ufl.edu	Keshav Memorial Institute of Technology	India
CISE	Akash	Kumar	akashkumar@ufl.edu	Lovely Professional University	India
CISE	Ayati	Maitra	maitraayati@ufl.edu	Amity University, Noida	India
CISE	Venkatesharam manoj	Malipeddi	Manojmalipeddi2001@gmail.co	Indian Institute of Technology Kharagpur	India
CISE	Archit	Mittal	mittalarchit@ufl.edu	Bennett University	India

HWCOE Current MS Student Assistance

UF Dept	First Name	Last Name	Email	Undergraduate Institution	Country
CISE	Abdul Sohail	Mohammed	masexplore21@gmail.com	Jawaharlal Nehru Technological University Hyderabad	India
CISE	Arpan	Nagar	arpannagar@ufl.edu	Manipal Institute of Technology, Manipal	India
CISE	Apoorva	Padhi	apoorvapadhi@ufl.edu	Amity University	India
CISE	Yash Raj	Pandey	pandey.yash@ufl.edu	Jaypee University of Engineering and Technology	India
CISE	Pranay Kumar Reddy	Pinninti	p.pinninti@ufl.edu	National Institute of Technology Raipur	India
CISE	Saurabh	SR	saurabh8599@gmail.com	Dayananda Sagar Academy of Technology and Managem	India
CISE	Rhea	Thomas	rheamthomas26@gmail.com	Reva University	India
CISE	Gayathri Reddy	Yeddla	gyeddla@ufl.edu	Jawaharlal Nehru Technological University, Hyderabad	India
ECE	Robert	Lattus	robertlattus@ufl.edu	Arizona State University	USA
ECE	Jianli	Mo	jianli.mo@ufl.edu	Hunan University of Information Technology	China
ECE	Samudra Vishal	Mukherji	smukherji@ufl.edu	Kalinga Institute of Industrial Technology	India
ECE	Manish Chowdary	Ravipati	ravipatim@ufl.edu	Anna University	India
ECE	Steven	Wei	weiq8848@gmail.com	Zhejiang University	China
EED	Gadhaun	Aslam	gadhaunaslam@ufl.edu	Forman Christian College	Pakistan
ESSIE	Giorgio	Carmagnani	g.carmagnani@ufl.edu	Universidade Federal do Rio Grande do Norte	Brazil
ESSIE	Darshan	Lingaraj	darshan.lingaraj@ufl.edu	GM Institute of technology	India
ISE	Siddharth Vipankumar	Abrol	sabrol@ufl.edu	Vishwakarma Institute of Information Technology	India
ISE	Jiamin	Chen	jjamin.chen@ufl.edu	Shanghai Jiao Tong University	China
MAE	George	Adedokun	oadedokun@ufl.edu	Ladoke Akintola University of Technology (LAUTECH)	Nigeria
MAE	Prasad	Jirolikar	pashupj@gmail.com	ACS College of Engineering	India
MAE	Bruce	Nti	ntibrucebaffour@gmail.com	Kwame Nkrumah University of Science and Technology	Ghana
MAE	Pengpeng	Zhang	pe.zhang@ufl.edu	Florida Institute of Technology	United States
MSE	Pavanbabu	Arjunamahanthi	arjunamahanth.pa@ufl.edu	National institute of technology, Srinagar	India
MSE	Gabrielle	Motilal	gabriellemotilal@ufl.edu	University of The West Indies	Trinidad and Tobago



UF | Herbert Wertheim
College of Engineering
UNIVERSITY *of* FLORIDA

POWERING THE NEW ENGINEER TO TRANSFORM THE FUTURE