

BME Student Safety Council  
Safety Newsletter:

# Emergency Safety Procedures



## Responding to chemical spills

A **minor spill** does not threaten the safety of nearby individuals. To handle it,

- Notify the people around you
- Wear PPE and stop the spill with absorbent materials in the spill kit
- Dispose of absorbents, decontamination equipment, spill material, etc. as hazardous waste through the EH&S chemical waste pickup request (online)

A **major spill** is an immediate danger to people around you or may cause fire or explosion. **Call EH&S!**

- Notify and evacuate all nearby people
- Activate the fire alarm
- Isolate the work space by placing a sign: "Do not enter – chemical spill"
- **Business hours: call EH&S (352) 392-8400**
- **After business hours: call UPD (352) 392-1111**

## Using the Dry Chemical Extinguisher

BME extinguishers are rated for the following:

**Remember; PASS**

**P - Pull**  
**A - Aim**  
**S - Squeeze**  
**S - Sweep**

**CLASS A** ORDINARY COMBUSTIBLES: wood, paper, rubber, fabrics and many plastics

**CLASS B** FLAMMABLE LIQUIDS & GASES: gasoline, oils, paint, lacquer and tar

**CLASS C** FIRES INVOLVING LIVE ELECTRICAL EQUIPMENT

Types of fire that **cannot** be quenched with a dry chemical extinguisher:

**CLASS D** COMBUSTIBLE METALS OR COMBUSTIBLE METAL ALLOYS (NO picture symbol)

**CLASS K** FIRES IN COOKING APPLIANCES THAT INVOLVE COMBUSTIBLE COOKING MEDIA vegetable or animal oils and fats

## BMS Building Evacuation

Emergency exit stairs are located west and east of the laboratory space.

Front of BMS Building

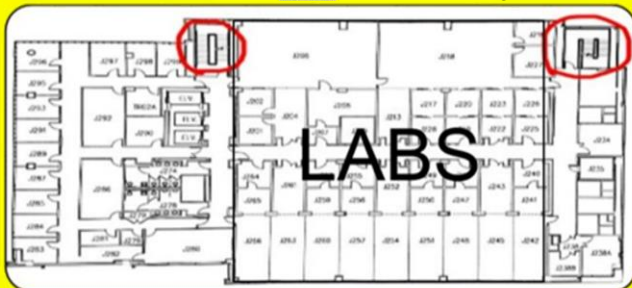

## Join "No Findings Club"

**FREE LUNCH** sponsored by College of Engineering in recognition of having **NO FINDINGS** on their EHS Annual Lab Safety Inspection.

Contact Amy (ahaberman@eng.ufl.edu) for more information.

\*Nominees to be distinguished in the next Newsletter!



## WE WANT TO HEAR FROM YOU

Email us with any BME safety questions, concerns, or suggestions:

[bmessc@bme.ufl.edu](mailto:bmessc@bme.ufl.edu)

## BME STUDENT SAFETY COUNCIL (SSC)

- Kaiyuan Jiang - PhD student, Stabler lab
- Nikunj Agrawal - PhD student, Schmidt lab
- Shannon Brown - PhD student, Sharma Lab
- Shaheen Farhadi - Master's student, Hudalla lab
- Jackson Cagle - Undergraduate, Ding lab
- Shujin Hackman - BME Lab Manager
- Dr. Peter McFetridge - Faculty Advisor